

WOOD



A2013

Punte elicoidali in hw (hm integrale) z=3
coniche per legno

*Hw (integral tungsten carbide) helical router bits
z=3 conical for wood*

MATERIALE LAVORATO / MATERIALS

legno duro, legno tenero, mdf
*hHrd wood, hHrd wood, mdf, soft
wood*

IMPIEGO / FUNCTION

centro lavoro cnc
cnc router

DESCRIZIONE / DESCRIPTION

Punte coniche , per finitura, Velocità di avanzamento: 2 - 10 m/min di 18 000 - 24 000 giri/min

Conical router bits, Finishing operation. Feed rate: 2 - 10 m/min of 18 000 - 24 000 RPM.

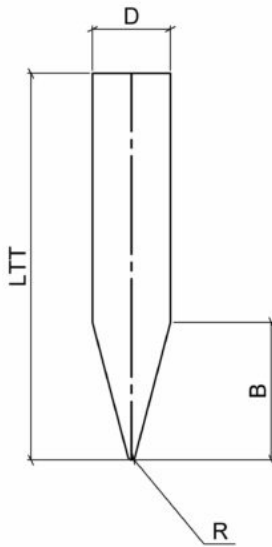

DATI TECNICI / TECHNICAL DATA

| ART | COD | DRW | D | B | LTT | Z | ROT | S | R | GT |
|-------|-----|-------|----|----|-----|---|-------|----|---|------------------------|
| A2013 | 001 | 45557 | 6 | 16 | 80 | 3 | Dx Rh | 6 | 1 | Positiva / Positive |
| A2013 | 002 | 45558 | 8 | 22 | 80 | 3 | Dx Rh | 8 | 1 | Positiva / Positive |
| A2013 | 003 | 45559 | 8 | 32 | 90 | 3 | Dx Rh | 8 | 1 | Positiva / Positive |
| A2013 | 004 | 45560 | 8 | 42 | 100 | 3 | Dx Rh | 8 | 1 | Positiva / Positive |
| A2013 | 005 | 45561 | 10 | 52 | 100 | 3 | Dx Rh | 10 | 1 | Positiva / Positive |
| A2013 | 006 | 45562 | 10 | 62 | 120 | 3 | Dx Rh | 10 | 1 | Positiva / Positive |
| A2013 | 007 | 45563 | 11 | 52 | 100 | 3 | Dx Rh | 11 | 1 | Positiva / Positive |
| A2013 | 008 | 45564 | 11 | 62 | 120 | 3 | Dx Rh | 11 | 1 | Positiva / Positive |
| A2013 | 009 | 45565 | 12 | 52 | 100 | 3 | Dx Rh | 12 | 1 | Positiva / Positive |
| A2013 | 010 | 45566 | 12 | 62 | 120 | 3 | Dx Rh | 12 | 1 | Positiva / Positive |

| ART | COD | DRW | D | B | LTT | Z | ROT | S | R | GT |
|-------|-----|-------|----|----|-----|---|-------|----|---|------------------------|
| A2013 | 011 | 45567 | 16 | 52 | 100 | 3 | Dx Rh | 16 | 1 | Positiva / Positive |
| A2013 | 012 | 45568 | 16 | 72 | 150 | 3 | Dx Rh | 16 | 1 | Positiva / Positive |
| A2013 | 013 | 45569 | 20 | 52 | 100 | 3 | Dx Rh | 20 | 1 | Positiva / Positive |
| A2013 | 014 | 45570 | 20 | 72 | 150 | 3 | Dx Rh | 20 | 1 | Positiva / Positive |